

ZHS-0720 Swing Solenoid

ISO/TS16949 ISO9000 ISO14000
RoHS REACH CE UL VDE TÜV



总重量 Total Weight: 60g
应用范围: 用于玩具等
APPLICATION: Toys etc

类型: 摆动式 TYPE: SWING TYPE

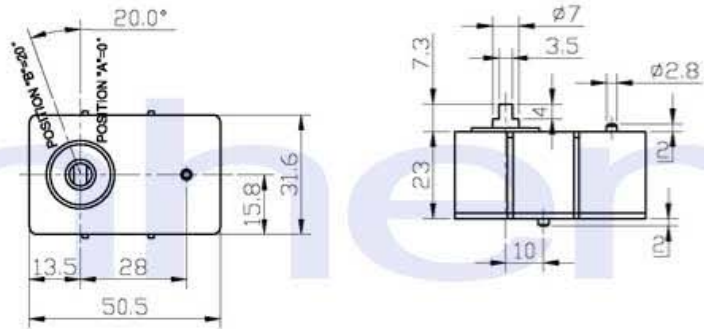

单位:mm Units:mm

综合特性 GENERAL FEATURES

- | | |
|---------------------------------|---|
| 1. 最低工作电压
LEAST WORK VOLTAGE | DC32.4V
DC32.4V |
| 2. 保持扭矩
KEEP FORCE | 0.8Nmm
0.8Nmm |
| 3. 温升
(TEMPERATURE RISE) | 在电压DC-36V下, 温升为85°CMax
AFTER DC-36V APPLIED BY RESISTANCE METHOD 85 deg MAX |
| 4. 寿命
(LIFE) | 典型值为10万次(通电0.1秒, 断电2秒)
REPETITIVE OPERATION FOR 0.1 MILLION CYCLE (ON:0.1Sec OFF:2Sec) at DC24V |
| 5. 耐电压
(DIELECTRIC STRENGTH) | 线圈和框架间AC1000V (50/60Hz) 1Min或
AC1200V (50/60Hz) 1Sec (击穿电流1mA)
BETWEEN COIL AND FRAME AC1000V (50/60Hz) 1Min OR
AC1200V (50/60Hz) 1Sec (1mA) |

COIL DATA线圈资料

工作周期(%) = $\frac{\text{工作时间}}{\text{工作时间} + \text{断开时间}} \times 100\%$ Duty cycle (%) = $\frac{\text{"ON" time}}{\text{"ON" time} + \text{"OFF" time}} \times 100\%$	间断 Or less 25%	间断 Or less 10%	间断 Or less 5%
最大工作时间(秒) MAX. "on" time in seconds	30		
瓦特(W) (在20°C) Watts at 20°C	36		
安匝数AT (在20°C) Ampere-turns at 20°C	1400		
型号 Type no.	阻值(20°C) Resistance (Ω) ±10%	起始扭矩 (Nmm) Starting Torque	电压(VDC) VoltS DC
ZHS-0720-XX A XX	4	0.8	12
电压Voltage (V)	16	0.8	24
系列号Serial No.: A, B, C...	36	0.8	36
电阻Resistance (Ω)	64	0.8	48

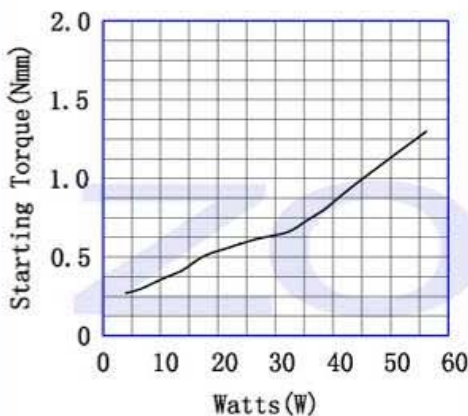

摆动式ZHS